

# ARDEN TOWN CENTER

NEC Watt Avenue and Fair Oaks Blvd  
Sacramento CA

## One Space For Lease at The Strongest Intersection in the County

- 831 SF Available
- >100,000 cars per day at this intersection
- Upscale Retail Center in High Income (\$125K+) Demographic
- Strong Tenant Mix with Food, Financial, Retail and Services



Jon Gianulias  
jg@corecre.com  
916. 799.2616  
CA BRE #01227233

CORE Commercial  
2264 Fair Oaks Blvd. Suite 201  
Sacramento, CA 95825  
www.corecre.com

**CORE**  
COMMERCIAL  
www.corecre.com

**AERIAL - AVAILABLE SPACE**

**FAIR OAKS BLVD - 39,800 ADT**

**WATT AVE - 53,979 ADT**



3519 Fair Oaks Blvd  
**AVAILABLE**  
± 831 SF

# SITE PLAN - AVAILABLE SITE

# ARDEN TOWN CENTER

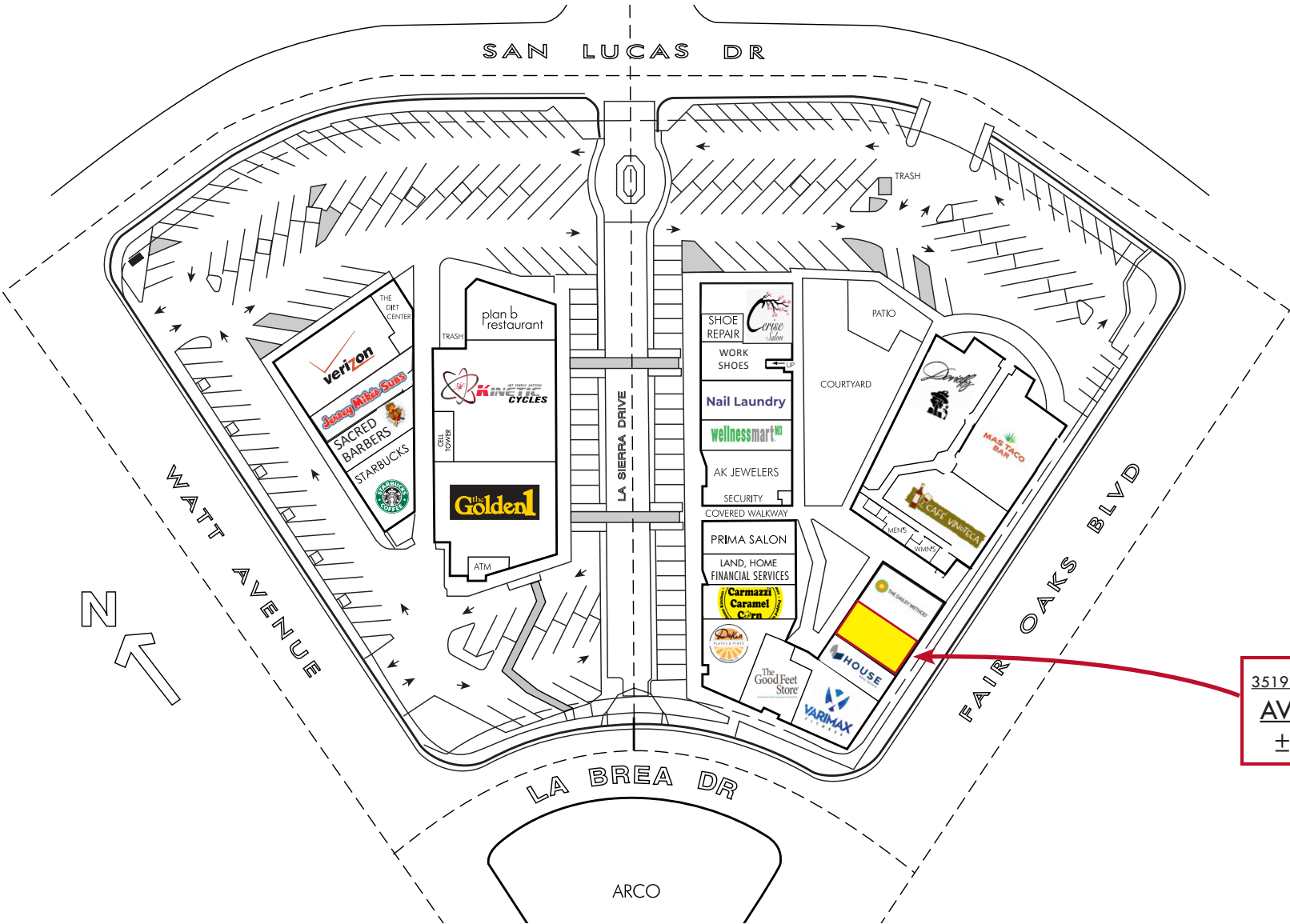

3519 Fair Oaks Blvd  
**AVAILABLE**  
± 831 SF



Jon Gianulias  
jg@corecre.com  
916. 799.2616  
CA BRE #01227233

**CORE**  
COMMERCIAL

# SITE PHOTOS - SIGNAGE AND COMMON AREAS

ARDEN  
TOWN CENTER



Fair Oaks Blvd Signage



Watt Ave Signage

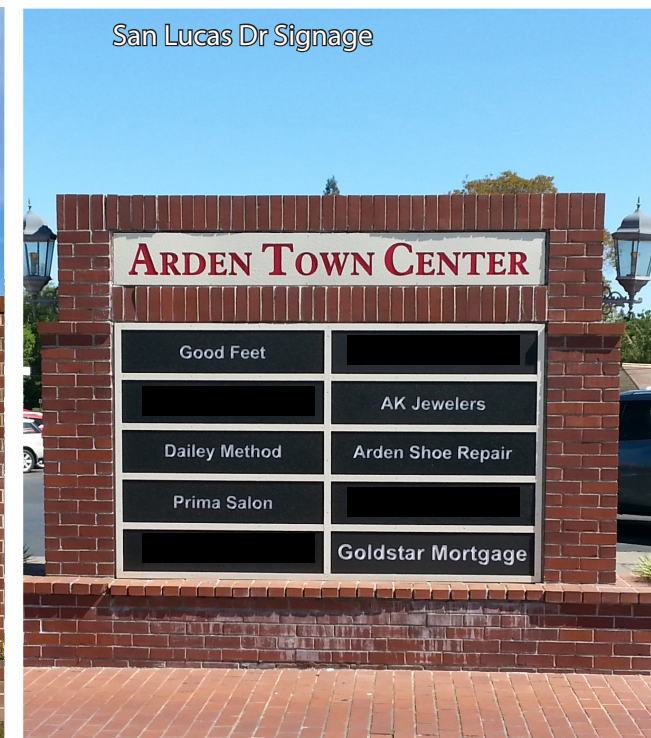

San Lucas Dr Signage

Jon Gianulias  
jg@corecre.com  
916. 799.2616  
CA BRE #01227233

CORE  
COMMERCIAL

# SITE PHOTOS - TENANTS

# ARDEN TOWN CENTER



Jon Gianulias  
jg@corecre.com  
916. 799.2616  
CA BRE #01227233

CORE  
COMMERCIAL

# AREA OVERVIEW

# ARDEN TOWN CENTER



## TRADE AREA DEMOGRAPHICS

2019 Estimated	3 Mile Radius
Population	131,308
Median Age	39
Average Household Income	\$90,878
Number of Businesses	8,449
Number of Employees	74,080
Bachelor and Graduate Degree	40.2%

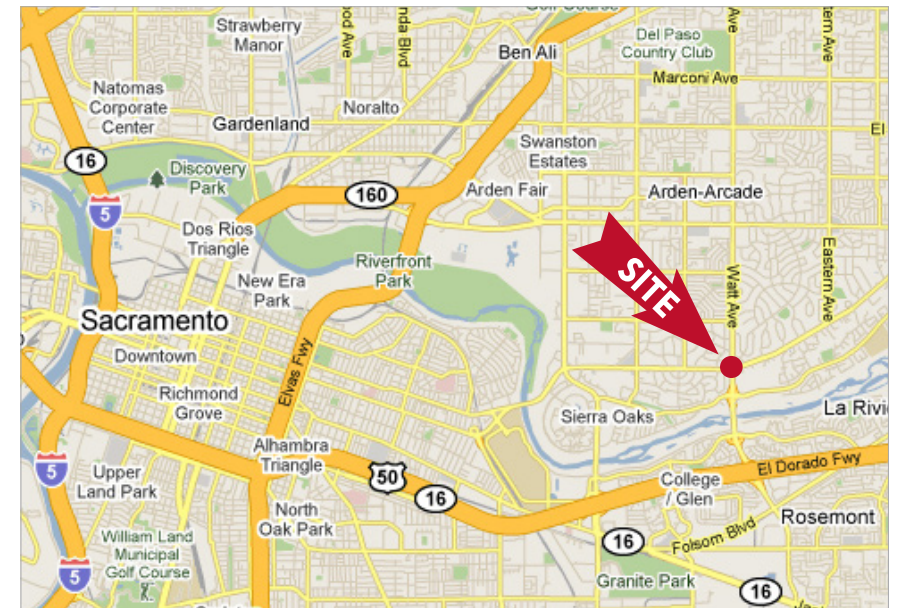

COPYRIGHT © 2020. ALL RIGHTS RESERVED. CORE Commercial (“Agent”), CA DRE Lic. 01904661, has presented this brief, selected information pertaining to the Property and shall not be considered all-inclusive or unchanged since the date of preparation. No warranty as to the accuracy or completeness is expressed or implied. The information has been received from sources believed to be reliable but is not guaranteed. Prospective Tenants should independently verify each item of information and have the same reviewed by its tax advisor and/or legal counsel. The Property is being leased on an “as-is, where-is” and “with all faults” basis unless otherwise specified.

**CORE**  
COMMERCIAL

[www.corecre.com](http://www.corecre.com)